

TECHNICAL DATA SHEET

LFAL IP20 / Aga-Led® Type B

VERSION - 06.07.2017

STANDARD LUMINAIRE

Reference	LFAL
Protection Class	IP20
Lighting Source	Aga-Led® Type B
Connector	Rigid Loop on B'Light conductor 16mm ²
Dimensions	13 x 21mm
Standard Length	330 - 670 - 1000 - 1330 - 1670 - 2000mm
Length on measure	on request up to 3000mm
Nb Lighting Unit	18 LED/m
Voltage	24V
Power	17.28 W/m to 21.60 W/m
Connecting Cable	COS3: 1m standard cable 2x1.5mm ²

APPLICATION: cornices, handrails, stairs, shelves



LFAL / AGA-LED® TYPE B - Rigid Loop

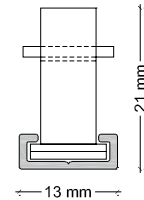

FINISH

Color Finishing Profil

Standard	Natural Anodised Aluminium
On request	Thermo-Enameling Powder Coating RAL Color Anodising Polished Aluminium Chrome Aspect Polished Aluminium Gold Aspect

ON REQUEST: LFAL Fixation

FCP-S (fixed with tape & screw)

FCP (fixed with screw)

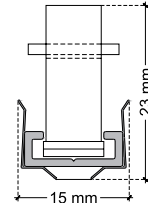
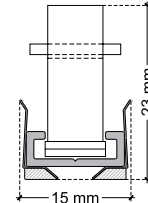

ON REQUEST

Fixation	BFA (fixed with screw) FCP (fixed with screw) FCP-S (fixed with tape & screw)
Connecting Cable	COS4 - COS4a
Connecting Plug	AMS / AF
Dimming Option	1-10V, Dali, KNX <i>Ask technical department for more information</i>

ON REQUEST: LFAL Fixation BFA

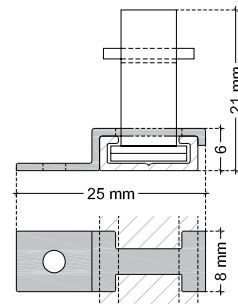

LIGHTING SOURCE

Lighting Source	Aga-Led® Type B - Generation 2	
Ref	B3	B6
Power	0.96W	1.2W
Voltage	24V	24V
Beam Angle	120°	120°
CRI	80	80
Lifetime	50'000h	
Working T°	-20°C to +45°C	
Environmental protection	Modified acrylate resin	

Color Temperature & Luminous Flux / Unit

	2200K	2400K	2700K	3000K	4000K
Aga-Led® B3-G2	-	97 lm	137lm	137lm	137lm
Aga-Led® B6-G2	129 lm	140 lm	166 lm	166 lm	166 lm

CERTIFICAT



ON REQUEST : Connecting Cable

COS4 Linear bridging



2x8cm conductors of 2.5mm²

COS4a Corner bridging



1x8cm conductors of 2.5mm²
1x11cm conductors of 2.5mm²

ON REQUEST : Connecting plug AF/AMS

